

## Poke Through Systems

### FPT Flush Series

The Steel City® FPT Poke Through Series provides an economical solution for installing a duplex receptacle in an existing floor — right where you need it.

- Capacity: 1 duplex receptacle
- Core drill size: 3"
- Brushed brass and aluminum covers provide superior aesthetics and durability
- Non-metallic covers are available in black, gray, beige and brown
- Non-metallic covers include openings for 3 communications cables
- Integral junction box features (5) ½" and (5) ¾" knockouts (27 cubic inch capacity)
- Assembled units include (1) 20A duplex receptacle, pre-wired with pigtail ends in junction box

#### Poke Through: 2 Power



CAT. NO.	DESCRIPTION	STD. CTN.
FPT-449	FPT Flush Poke-Through Assembly: Base Unit with Solid-Brass Cover	1
FPT-450	FPT Flush Poke-Through Assembly: Base Unit with Solid-Aluminum Cover	1
FPT-445-SW-BLK	FPT Flush Poke-Through Assembly: Base Unit with Black Non-Metallic Cover	1
FPT-445-SW-GRY	FPT Flush Poke-Through Assembly: Base Unit with Gray Non-Metallic Cover	1
FPT-445-SW-BGE	FPT Flush Poke-Through Assembly: Base Unit with Beige Non-Metallic Cover	1
FPT-445-SW-BRN	FPT Flush Poke-Through Assembly: Base Unit with Brown Non-Metallic Cover	1
FPT-400B	FPT Poke-Through Base Unit Only (no duplex): Cover Purchased Separately	1

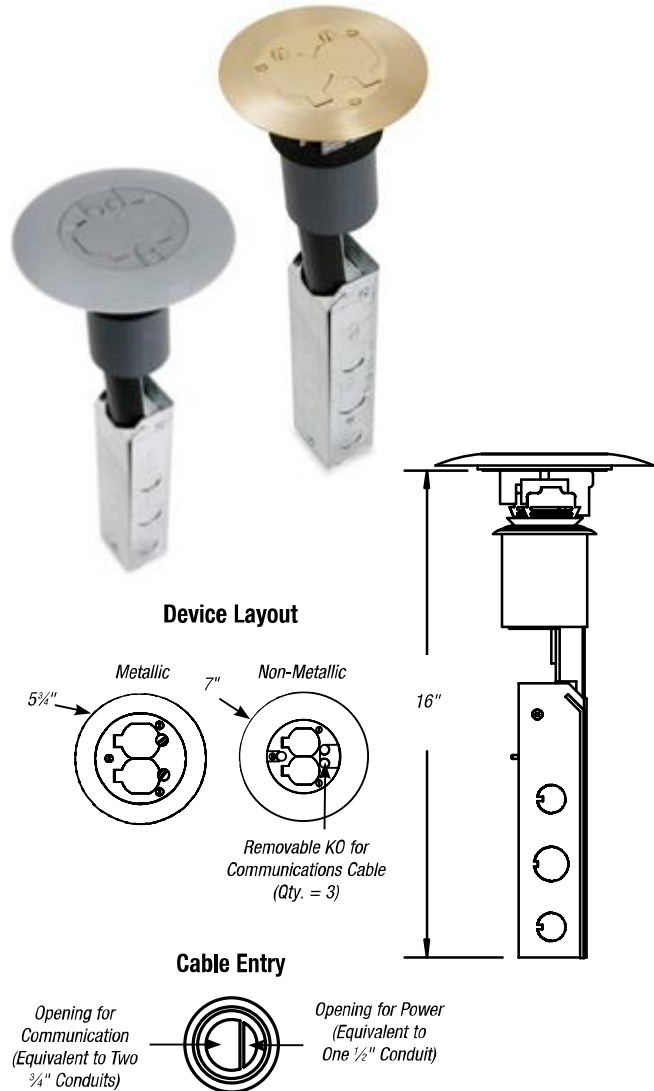

Boxes & Covers — Steel City® Floor Boxes

### Poke-Through Covers

- Non-metallic covers feature 3 openings for communications cables



CAT. NO.	DESCRIPTION	STD. CTN.
FPT-CACP	Solid Brass, Brushed Finish, 5 ¼" Diameter	10
FPT-CACP-AL	Solid Aluminum, Brushed Finish, 5 ¼" Diameter	10
FPT-441-SW-BLK	Black, Non-Metallic, 7" Diameter	10
FPT-441-SW-GRY	Gray, Non-Metallic, 7" Diameter	10
FPT-441-SW-BGE	Beige, Non-Metallic, 7" Diameter	10
FPT-441-SW-BRN	Brown, Non-Metallic, 7" Diameter	10

#### Brushed Metal Finishes



FPT-CACP



FPT-CACP-AL

#### Non-Metallic Colors and Finishes



FPT-441-SW-BLK



FPT-441-SW-GRY



FPT-441-SW-BGE



FPT-441-SW-BRN