



# High Output T12

## F96T12/D/HO-O ALTO 15PK

Philips T12 fluorescent lamps provide high performance in a wide range of sizes, shapes, and types.

### Product data

| General Information         |   |
|-----------------------------|---|
| Cap-Base                    | R17D [ R17d (RDC)]  |
| Life 3-Hr Start [Hrs]       | 12000 h   |
| Features                    | ALTO® (ALTO)  |
| Footnotes Fluorescent/CFL 1 | Meets the National Energy Policy Act of 1992 exemption for outdoor or cold temperature applications only. (223) |

| Light Technical                    |          |
|------------------------------------|----------|
| Color Code                         | 54       |
| Initial lumen (Nom)                | 7800 lm  |
| Color Designation                  | Daylight |
| Design Mean Lumens                 | 6800 lm  |
| Correlated Color Temperature (Nom) | 6500 K   |
| Color Rendering Index (Nom)        | 79       |

| Operating and Electrical |       |
|--------------------------|-------|
| Power (Rated) (Nom)      | 110 W |

| Mechanical and Housing |            |
|------------------------|------------|
| Cap-Base Information   | Green Base |
| Nominal Length (Inch)  | 96         |

| Approval and Application   |                |
|----------------------------|----------------|
| Energy Saving Product      | Not Applicable |
| Mercury (Hg) Content (Nom) | 6.8 mg         |

| Product Data                    |                         |
|---------------------------------|-------------------------|
| Order product name              | F96T12/D/HO-O ALTO 15PK |
| EAN/UPC - Product               | 046677381776            |
| Order code                      | 381774                  |
| Numerator - Quantity Per Pack   | 1                       |
| Numerator - Packs per outer box | 15                      |
| Material Nr. (12NC)             | 927895205408            |
| Net Weight (Piece)              | 0.694 kg                |

### Warnings and Safety

- Lamp contains mercury. Manage in Accord with Disposal Laws. See: [www.lamprecycle.org](http://www.lamprecycle.org) or 1-800-555-0050

# High Output T12

## Dimensional drawing

### Product

F96T12/D/HO-O ALTO 15PK

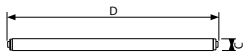

T12 Revised Double Contact

F96T12 110W/54 HO-O ALTO

