

Drains & Breathers

Type DB & Type DBB

Use:

May be used as a combination drain or breather. When installed at the top of an enclosure it acts as a breather. When installed in the bottom of an enclosure it acts as a drain for moisture inside the enclosure.

Features:

Tapered threads (NPT)

Material/Finish:

Stainless Steel

Third Party Certification:



UL Listed: E-34997

Type DB:

Class I, Div. 1, 2, Groups C, D
Class I, Zone 1, 2, Groups IIA, IIB
Class II, Div. 1, 2, Groups F, G
Class III

Type DBB:

Class I, Div. 1, 2, Groups B, C, D
Class I, Zone 1, 2, Groups IIA, IIB + H₂
Class II, Div. 1, 2, Groups E, F, G
Class III



CSA Certified: 009795

Applicable Third Party Standards:

UL Standard: 886

CSA Standard: C22.2 No. 30

NEC Articles 500-503 & 505

Trade Size (inches)	Catalog Number	Dimensions in inches		
		Length	Max Dia	A
3/8	DB-38*	1 5/16	1 1/16	1 5/16
1/2	DB-50	1 1/2	1	1 1/2
1/2	DBB-50SS	1 11/16	1 5/16	2 1/16

*UL component recognized

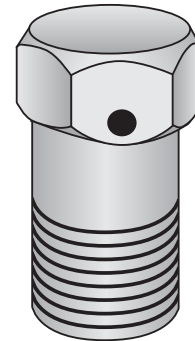
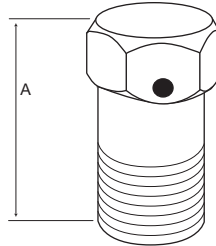

Type DB

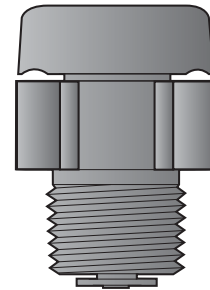

Type DBB