

## FEATURES & SPECIFICATIONS

**INTENDED USE** — Provides minimum 90 minutes of illumination for rated wattage upon loss of AC power. Unique design for light and heavy industrial applications, as well as heavy commercial environments. Superior performance lamp heads are ideal for higher mounting heights.

**CONSTRUCTION** — Rugged, .140" thick, injection-molded thermoplastic (large back housing is .187" thick, compression-molded composite). Vertical orientation, designed for pole or column mounting. Also suitable for wall, I-beam and uni-strut mounting. Easy installation with epoxy-coated, corrosion-resistant, 12-gauge steel mounting bracket shipped standard. **US Patent No. 6,135,624 – Mounting Bracket Utility Patent.** Conduit entry points located on top and both sides of unit. Maintenance made easy by tool-less lamp replacement, hinged front cover, printed circuit board mounting shelf and battery belt. **US Patent No. D419,097 – Design Patent.**

**OPTICS** — Lamps: US Patent No. 6,193,395 – Lamp Head Utility patent. Full range of lamp options available from 9W to 50W in sealed-beam or composite versions of incandescent, krypton or halogen lamps. Composite lamps feature unique field-adjustable beam spread (by turning lamp bezel). Standard lamp is 9W krypton, for 6V and 12V. Standard lamp is 18W incandescent for 24V.

**ELECTRICAL** — Dual voltage input capacity 120/277.

Brownout protection is standard feature.

AC/LVD reset prevents battery damage from deep discharge.

Current limiting charger.

Thermal protection prevents overheating and charger failure.

Thermal compensation provides optimum charge voltage relative to ambient temperature.

Battery: Sealed, maintenance-free, lead-acid (SLA) battery with capacity for 90 minutes of emergency operation.

Low-voltage disconnect prevents excessively deep discharge that can permanently damage battery.

Premium and Ultimate options offer high-temperature batteries (IND618, IND1236 and IND12100 only). UL listed from 32°F to 131°F (0°C to 55°C) (Premium) or -40°F to 131°F (-40°C to 55°C) (Ultimate).

Single multi-color LED indicator displays two-state charging, test activation and three-state diagnostic status. Test switch provides manual activation of 30-second diagnostic testing for on-demand visual inspection. Diagnostic evaluation of LED light source, AC to DC transfer, charging and battery condition. Continuously monitors AC functionality. Load-learning capability self-calibrates to DC load at first test, enabling it to detect a lamp failure on future tests. It may be recalibrated at any time by holding down the test switch for 15 seconds. Self-diagnostic testing for five minutes every 30 days and 30 minutes every six months.

**INSTALLATION** — Column and pole mounting standard (12-gauge steel mounting bracket included). Other mounting options available for ceiling mount or I-Beam mounting (see accessories).

**LISTINGS** — UL damp location listed standard 50°-104°F (10°-40°C). Meets UL924, NFPA 101 (current Life Safety Code), NEC and OSHA illumination standards. Meets all applicable FCC requirements.

Catalog Number
Notes
Type



Industrial Emergency Lighting Unit

# IND6/12/24



IND12100

Small Housing



IND12150

Large Housing

Lead-Acid (SLA) Battery

**WARRANTY** — Three-year limited warranty. (Battery is prorated.) Complete warranty terms located at [www.acuitybrands.com/CustomerResources/Terms\\_and\\_conditions.aspx](http://www.acuitybrands.com/CustomerResources/Terms_and_conditions.aspx)

**Note:** Actual performance may differ as a result of end-user environment and application. Specifications subject to change without notice.

### ORDERING INFORMATION

For shortest lead times, configure product using standard options (**shown in bold**).

**Example:** IND12100 H5012S SEL

Series	Housing color	Lamp type (2 heads)	Options
<b>6 Volts</b>	<b>(blank)</b> Gray front / navy back	<b>6 Volts</b>	<b>(blank)</b> Damp location 50° F to 104° F (10° C to 40° C). XTRA Extra package. Features remote test, time delay and damp location 50°F to 104°F (10°C to 40°C). <sup>4</sup>
<b>IND618</b> 18W		PAR36 Composite	
<b>IND654</b> 54W	W White	<b>(blank)</b> 9W/6V krypton	<b>SEL</b> Select package. Features self-diagnostics, time delay, audible failure indication and damp location 50° F to 104° F (10° C to 40° C).
IND6100 100W <sup>1</sup>		H1206 12W/6V halogen	
<b>12 Volts</b>		<b>H2006</b> 20W/6V halogen	<b>PREM</b> Premium package. Features high-temperature ni-cad battery (IND618 and IND1236 only) or high-temperature lead calcium battery (IND12100 only), self-diagnostics, time delay, audible failure indication and damp location. UL listed for 32° F to 131° F (0° C to 55° C). <sup>5,7</sup>
IND1236 36W		PAR36 Composite	
<b>IND1254</b> 54W		<b>(blank)</b> 9W/12V krypton	<b>ULT</b> Ultimate package. Features heater, thermostat and battery blanket with a high temperature ni-cad battery (IND618 and IND1236 only) or high-temperature lead-calcium battery (IND12100 only), self-diagnostics, time delay, audible failure indication and damp location. UL listed for -40° F to 131° F (-40° C to 55° C). <sup>5,7</sup>
<b>IND12100</b> 100W <sup>2</sup>		H1212 12W/12V halogen	
IND12150 150W <sup>2</sup>		<b>H2012</b> 20W/12V halogen	<b>T20C</b> California Title 20 Compliance <sup>8</sup>
IND12300 300W <sup>2</sup>		PAR36 Sealed-Beam	
IND12450 450W <sup>2</sup>		H3512S 35W/12V halogen	
<b>24 Volts</b>		<b>H5012S</b> 50W/12V halogen	
IND24100 100W <sup>2</sup>			
IND24450 450W <sup>1,2</sup>			

### Accessories: Order as separate catalog number

ELA RTT	Remote test transmitter <sup>4</sup>	ELA IND CM1	Ceiling mount kit for IND618 <sup>3</sup>
ELA WG2M	Wire guard - small (18W-100W) <sup>9</sup>	ELA IND CM2	Ceiling mount kit for IND654/1236/1254 <sup>3</sup>
ELA WGLG	Wireguard - large (150-450W) <sup>9</sup>	ELA IND CM3	Ceiling mount kit for IND6100 <sup>3</sup>
ELA BS	Banding Strap <sup>4</sup>	ELA IND R3	Pre-pack to install third head <sup>10</sup>
ELA IND PM	Pendant mount kit for IND618/654/6100/1236/1254/12100/24100 <sup>6</sup>		

### NOTES:

- DL listed for indoor applications.
- Not suitable for ceiling mount.
- Required for ceiling mount. Color is not a factor. See spec sheet [ELA-IND-PM-CM-RHB-R3](#).
- Must order a Remote transmitter (ELA RTT). One per job required. See spec sheet [ELA-RTT-BS](#).
- Only available on IND618, IND1236 and IND12100.
- ELA IND PM accessory cannot be used with the IND12100 PREM or IND12100 ULT. Color is not a factor. See spec sheet [ELA-IND-PM-CM-RHB-R3](#).
- IND12100 PREM and IND12100 ULT come in a larger housing size.
- See T20C compliant [product list](#). Only available with IND618.
- See spec sheet [ELA-WG](#).
- See spec sheet [ELA-IND-PM-CM-RHB-R3](#).

# IND6-12-24 INDURA Industrial Emergency Lighting Units, 6/12/24 Volts

## SPECIFICATIONS

ELECTRICAL: Primary Circuit								
Type	Volts	AC Input Amps <sup>1</sup>	Watts	Output Volts	1-1/2 hrs.	2 hrs.	3 hrs.	4 hrs.
IND618	120	.163	19.6	6	18	13.5	9	6
	277	.069	19.11					
IND654	120	.172	20.64	6	54	40	27	20
	277	.075	20.78					
IND6100	120	.171	20.5	6	100	75	50	37
	277	.064	17.7					
IND1236	120	.174	20.9	12	36	27	18	13
	277	.078	21.61					
IND1254	120	.174	20.88	12	54	40	27	20
	277	.078	21.6					
IND12100	120	.174	20.88	12	100	75	50	37
	277	.074	20.49					
IND12150	120	.359	43.08	12	150	112	75	56
	277	.168	46.54					
IND12300	120	.290	34.8	12	300	225	150	112
	277	.130	36.1					
IND12450	120	.33	39.96	12	450	337	225	168
	277	.15	43.77					
IND24100	120	.33	39.6	24	100	75	50	37
	277	.15	41.55					
IND24450	120	.773	92.76	24	450	337	225	168
	277	.327	90.58					

## BATTERY

High-Temperature Nickel-Cadmium				
Voltage	Shelf life <sup>2</sup>	Typical life <sup>3</sup>	Maintenance <sup>4</sup>	Optimum Temperature <sup>5</sup>
6/12/24	3 yrs.	7-9 yrs.	none	32°-131°F (0°-55°C)
Lead-Acid (SLA)				
Voltage	Shelf life <sup>2</sup>	Typical life <sup>3</sup>	Maintenance <sup>4</sup>	Optimum Temperature <sup>5</sup>
6/12/24	1 yr.	3-5 yrs.	none	50°-104°F (10°-40°C)
High-Temperature Lead-Acid (SLA)				
Voltage	Shelf life <sup>2</sup>	Typical life <sup>3</sup>	Maintenance <sup>4</sup>	Optimum Temperature <sup>5</sup>
6/12/24	1 yr.	5-7 yrs.	none	32°-131°F (0°-55°C)

### NOTES:

- For ULT option, consult factory for input power factor, if required.
- At 77°F (25°C).
- Based on normal room temperatures and conditions.
- All life safety equipment, including emergency lighting for path of egress must be maintained, serviced, and tested in accordance with all National Fire Protection Association (NFPA) and local codes. Failure to perform the required maintenance, service, or testing could jeopardize the safety of occupants and will void all warranties.
- Optimum ambient temperature range where unit will provide rated capacity for 90 minutes. Higher and lower temperatures affect life and capacity.

## KEY FEATURES

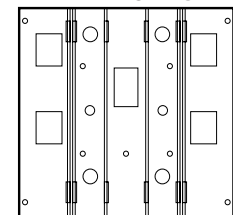

12-gauge epoxy-coated steel mounting bracket included with each unit.

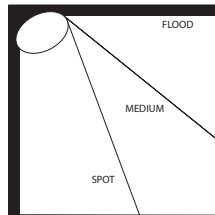

Field-adjusted beam pattern for composite lamps.

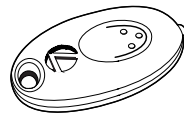

Order remote transmitter separately.

## MOUNTING

All dimensions are inches (centimeters).

Shipping weight:

IND618 - 13 lbs. (5.9 kgs)	IND12150 - 45 lbs. (20.4 kgs)
IND654 - 18 lbs. (8.2 kgs)	IND12300 - 72 lbs. (32.7 kgs)
IND6100 - 23 lbs. (10.4 kgs)	IND12450 - 75 lbs. (30.0 kgs)
IND1236 - 18 lbs. (8.2 kgs)	IND24100 - 27 lbs. (12.2 kgs)
IND1254 - 18 lbs. (8.2 kgs)	IND24450 - 75 lbs. (30.0 kgs)
IND12100 - 27 lbs. (12.2 kgs)	

Large Housing (100W PREM and ULT; 150-450W)

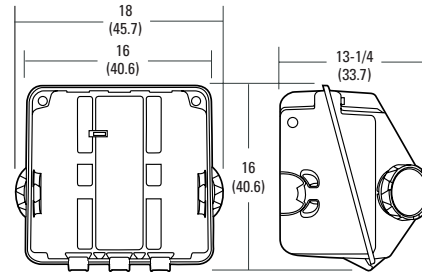

Small Housing (18-54W; 100W Standard, XTRA, and SEL)

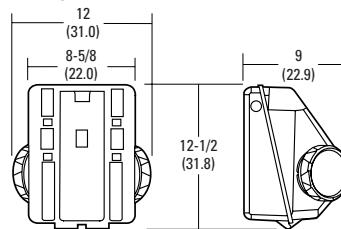

Mounting bracket

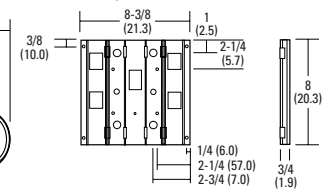

## PHOTOMETRICS

ELA IND K0906  
One (1) 9 Watt Krypton In Vertical, Base Up Position

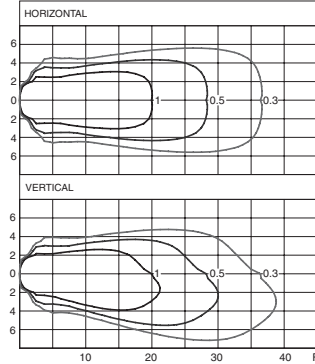

ELA IND K0912  
One (1) 9 Watt Krypton In Vertical, Base Up Position

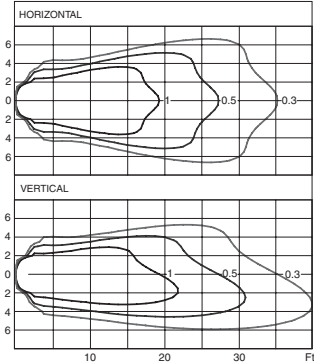

## PERFORMANCE DIAGRAM

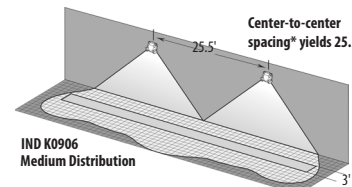

\*Note: Meets Life Safety Code standard minimum illuminance of 0.1 FC and average illuminance of 1.0 FC. Assumes space of 200'L x 200'W x 30'H, mounting height: 12', ceiling height: 30', and reflectances: 10/10/10. Analysis based on independently tested photometrics.

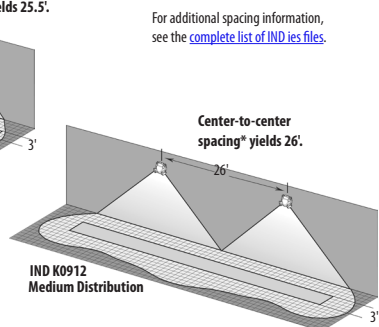

For additional spacing information, see the [complete list of IND ies files](#).