



## HID Wall Pack - WL Series



WL150MH-PS

### INSTALLATION INSTRUCTIONS

### WL150MH-PS 150 Watt Metal Halide Pulse Start

**FOR OUTDOOR USE ONLY**  
**NOT FOR USE IN HAZARDOUS ATMOSPHERES**

**IMPORTANT: Read instruction sheet carefully before installing fixture.**  
**Retain instructions for future reference.**

#### ELECTRICAL REQUIREMENTS

Models WL150MH-PS will accept 120, 208, 240 or 277 Volts AC. Fixtures must be properly grounded for safety. A mounting suitable for outdoor use is required. Fixture is approved for mounting in "UL Wet Locations". (Install a minimum of 1.2 m (4 ft) off the ground).

**⚠ WARNING Electric Shock and Fire Hazard**

This fixture is designed to be installed by a qualified electrician. All electrical components, connections, boxes etc., to be installed in accordance with the National Electrical Code and any other applicable regulations.

**⚠ WARNING Electric Shock Hazard**

Disconnect power at circuit breaker or fuse box before installing or servicing light.

**⚠ WARNING Electric Shock and Fire Hazard**

FOR SUPPLY CONNECTION IN EXTERNAL JUNCTION BOX USE MINIMUM 90°C CONDUCTORS.  
FOR CONNECTIONS MADE INSIDE FIXTURE USE MINIMUM 125°C CONDUCTORS.

Lamp housing becomes very hot during use. Ensure free air circulation around unit to dissipate heat. Avoid enclosed locations and locations where flammable debris (leaves, cut grass, etc.) might collect. Avoid locations where humans or animals might accidentally touch fixture.

**⚠ WARNING Fire, Burn and Explosion Hazard**

Wear safety glasses and gloves when handling lamp. Outer envelope of lamp could explode.  
Never operate light without securing the lens door. When light is operating, the gas in the lamp inner arc tube is at high pressure. Never operate light if the fixture lens or outer glass envelope of the lamp is broken or missing.

**⚠ CAUTION UV Hazard (Metal Halide Lamps Only)**

The type of lamp used in this fixture can cause serious skin burn and eye inflammation from short wave ultra violet radiation if outer envelope of the lamp is broken or punctured, and the arc tube continues to operate. Replace damaged lamp immediately. Use only type E lamps. Certain types of lamps that will automatically extinguish when the outer envelope is broken or punctured are commercially available.

**⚠ CAUTION**

This product contains chemicals known to the state of California to cause cancer, birth defects, and/or other reproductive harm. Thoroughly wash hands after installing, handling, cleaning or otherwise touching this product.

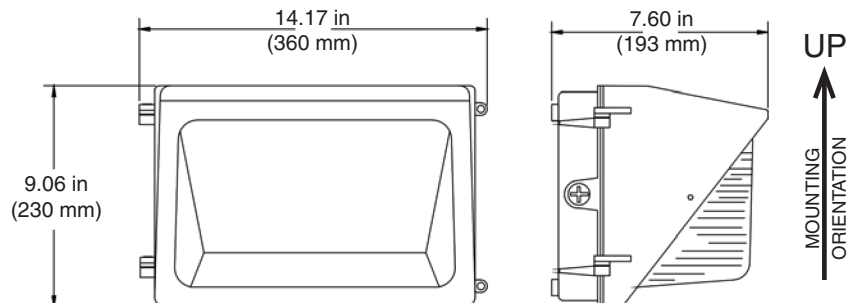
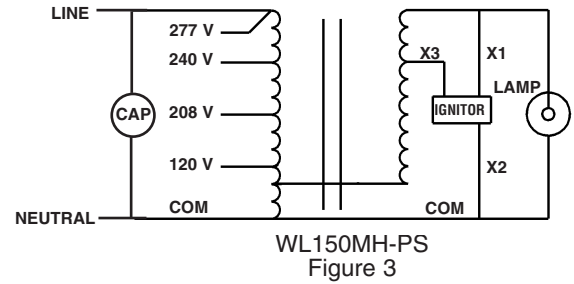
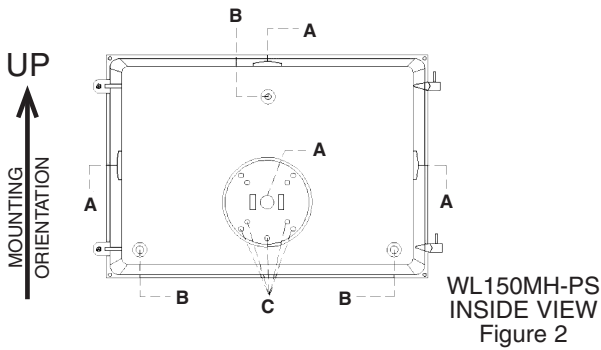

Figure 1(WL150MH-PS)

#### MOUNTING & WIRING

1. Disconnect power before installing.
2. Loosen (2) screws, open, and remove fixture lens cover. Set lens cover aside to prevent damage while installing. (See Figure 1)
3. Loosen screws and remove reflector and insulator.



## MOUNTING & WIRING (continued)

4. Prepare the back plate for mounting by drilling or knocking out the appropriate holes. (Figure 2)  
The back plate has a Cast-In Drill and Knockout Template to match any standard recessed junction box.  
Additional knockouts and holes: A-1/2"NPS Tapped Holes, B-5/16" Dia. Knockouts, Knockouts for #10 screw.
5. Select appropriate fixture wire to match incoming voltage. All models are shipped with 277V wire ready for connection. If supply voltage is lower, cap wire marked 277V with appropriate twist on wire connector and strip fixture wire marked with matching voltage. (See Figure 3)
6. Feed the matching voltage fixture wire, fixture wire marked "COM", and fixture grounding wire out of the fixture.
7. Confirm all unused voltage fixture wires are appropriately capped within fixture body.
8. Mount fixture securely to wall. Fixture should be mounted horizontal. (See Figure 1) Use silicone sealant around back plate.
9. Using provided twist on or other approved connectors, connect the fixture wires to the supply wires.
  - a. Connect the selected voltage fixture wire to the Black (hot) supply wire.
  - b. Connect the White fixture wire marked "COM" to the White (neutral) supply wire.
  - c. Connect the Green (fixture ground) wire to the supply grounding wire.
10. Install reflector and insulator with screws.
11. Screw lamp into lampholder until finger-tight.
12. Install, close, and secure lens cover with (2) screws making sure that the gasket is properly seated. To weatherproof fixture, seal all holes in housing (mounting, conduit, plugs, photocontrols, etc.) with silicone sealant.
13. To operate, restore power to the circuit and switch light on.

### **CAUTION (Metal Halide Lamps Only) Risk of Lamp Rupture**

To reduce risk of lamp rupture, do not use lamp beyond manufacturer's rated life. Turn lamp off at least once for 15 minutes per week.

## LAMP REPLACEMENT

### **CAUTION**

Use lamp of correct type and wattage as specified on fixture.

1. Turn off power at circuit breaker or fuse box. Allow fixture and lamp to cool.
2. Loosen (2) screws, open and remove fixture lens cover. Wear gloves and safety glasses. Remove old lamp and replace with new lamp of correct type and wattage. Screw lamp into socket in lampholder until finger-tight.
3. Install, close, and secure lens cover with (2) screws making sure that gasket is properly seated, free of debris, and compressed to seal out moisture.
4. Turn power back on.
5. Properly dispose of lamp per manufacturer's recommendations and all applicable regulations.

## TROUBLE SHOOTING

IF LIGHT DOES NOT WORK:	Check your Power Source. Check to Insure Proper Seating of Lamp.	Check Electrical Connections. Check if Lamp is Burned Out.
-------------------------	---	---

### Limited One Year Warranty

If within the warranty period specified, this product fails due to a defect in material or workmanship, Intermatic Incorporated will repair or replace it, at its sole option, free of charge. This warranty is extended to the original household purchaser only and is not transferable. This warranty does not apply to: (a) damage to units caused by accident, dropping or abuse in handling, acts of God or any negligent use; (b) units which have been subject to unauthorized repair, opened, taken apart or otherwise modified; (c) units not used in accordance with instructions; (d) damages exceeding the cost of the product; (e) sealed lamps and/or lamp bulbs, LED's and batteries; (f) the finish on any portion of the product, such as surface and/or weathering, as this is considered normal wear and tear; (g) transit damage, initial installation costs, removal costs, or reinstallation costs.

INTERMATIC INCORPORATED WILL NOT BE LIABLE FOR INCIDENTAL OR CONSEQUENTIAL DAMAGES. SOME STATES DO NOT ALLOW THE EXCLUSION OR LIMITATION OF INCIDENTAL OR CONSEQUENTIAL DAMAGES, SO THE ABOVE LIMITATION OR EXCLUSION MAY NOT APPLY TO YOU. THIS WARRANTY IS IN LIEU OF ALL OTHER EXPRESS OR IMPLIED WARRANTIES. ALL IMPLIED WARRANTIES, INCLUDING THE WARRANTY OF MERCHANTABILITY AND THE WARRANTY OF FITNESS FOR A PARTICULAR PURPOSE, ARE HEREBY MODIFIED TO EXIST ONLY AS CONTAINED IN THIS LIMITED WARRANTY, AND SHALL BE OF THE SAME DURATION AS THE WARRANTY PERIOD STATED ABOVE. SOME STATES DO NOT ALLOW LIMITATIONS ON THE DURATION OF AN IMPLIED WARRANTY, SO THE ABOVE LIMITATION MAY NOT APPLY TO YOU.

This warranty service is available by either (a) returning the product to the dealer from whom the unit was purchased or (b) completing a warranty claim online at [www.intermatic.com](http://www.intermatic.com). This warranty is made by: Intermatic Incorporated, Customer Service 7777 Winn Rd., Spring Grove, Illinois 60081-9698. For warranty service go to: <http://www.intermatic.com> or call 815-675-7000.