

# CADDY SPEED LINK SLK with Toggle – SLK15L1T

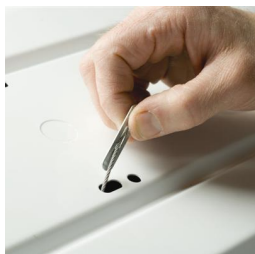

- Complete system includes wire, locking device and pre-assembled toggle end fitting
- Attaches to clearance holes in a variety of structures or hanging devices
- Ideal for supporting lighting fixtures
- Also available in Y-toggle configuration

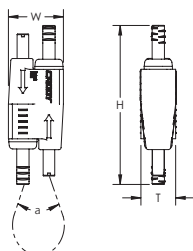
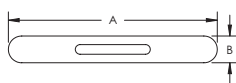
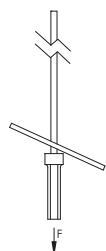

Part Number	SLK15L1T
Material	Steel Zinc Alloy Polypropylene
Finish	Electrogalvanized
Static Load Safety Factor	5:1
Wire Rope Diameter	1.5 mm
Wire Rope Length	3.3'
A	1 1/2"
B	0.2"
Static Load (F)	44 lb
Height (H)	2.15"
Width (W)	3/4"
Thickness (T)	1/2"
Angle (a)	90° Max
Certifications	cULus
Standard Packaging Quantity	20 pc
UPC	78285680152
EAN-13	8711893135251



UL, UR, cUL, cUR, cULus and cURus are registered certification marks of UL LLC.

**WARNING**

Pentair products shall be installed and used only as indicated in Pentair's product instruction sheets and training materials. Instruction sheets are available at [erico.pentair.com](http://erico.pentair.com) and from your Pentair customer service representative. Improper installation, misuse, misapplication or other failure to completely follow Pentair's instructions and warnings may cause product malfunction, property damage, serious bodily injury and death and/or void your warranty.

© 2017 Pentair All rights reserved

Pentair, CADDY, CADWELD, CRITEC, ERICO, ERIFLEX, ERITECH and LENTON are owned by Pentair or its global affiliates.

All other trademarks are the property of their respective owners. Pentair reserves the right to change specifications without prior notice.

