

Cable to Steel or Cast Iron, Cathodic – CAHAA1H

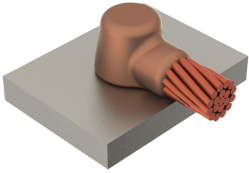

ERICO CADWELD Cathodic Connections are the preferred method of exothermically welding cathodic protection anode leads to pipes (steel or cast iron), tanks, and other structures. Cathodic protection systems are designed to prevent galvanic corrosion along a pipeline or in various structures. ERICO CADWELD Cathodic Connections use a special welding material alloy to minimize heat effect on the steel, which is especially important on thin wall and high stress pipes.

- Forms a permanent, low resistance connection
- Provides a molecular bond
- ERICO CADWELD Exothermic Connections are rated with the same current capacity as the conductor
- Portable installation equipment with no external source of power required
- Installers can be easily trained to make ERICO CADWELD Exothermic Connections
- Connections can be visually inspected

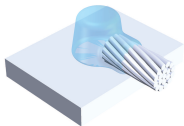

Part Number	CAHAA1H
Mold Family	HA
Connects To	Steel Pipe or Flat Surface
Conductor Size	#6 Concentric
Conductor Outer Diameter, Nominal	0.184"
Pipe Size	24" Min
Outer Diameter	24" Min
Split Crucible	No
Wear Plates	No
Mold Only	No
Welding Material	CA15 or CA15PLUSF33, Sold Separately
Handle Clamp	B323N2 and B322, Sold Separately
Frame	Attached
Price Key	A
Ease of Use	Preferred

Part Number	CAHAA1H
Standard Packaging Quantity	1 pc
UPC	78285653109
EAN-13	8711893069600

For applications such as computer room, tunnel or other low-ventilation areas, specify a smokeless ERICO CADWELD EXOLON mold. Add an XL prefix to the standard mold part number when ordering (for example, a TAC2Q2Q becomes XLTAC2Q2Q). Similarly, ERICO CADWELD EXOLON welding material is also designated by the XL prefix (for example, 150 becomes XL150).

A test weld should be made to check for the possibility of burn through on thin sections and to determine detrimental metallurgical effects.

Use XF19 or PLUSXF19 welding material on connections to ductile iron.

WARNING

Pentair products shall be installed and used only as indicated in Pentair's product instruction sheets and training materials. Instruction sheets are available at erico.pentair.com and from your Pentair customer service representative. Improper installation, misuse, misapplication or other failure to completely follow Pentair's instructions and warnings may cause product malfunction, property damage, serious bodily injury and death and/or void your warranty.

© 2017 Pentair All rights reserved

Pentair, CADDY, CADWELD, CRITEC, ERICO, ERIFLEX, ERITECH and LENTON are owned by Pentair or its global affiliates.

All other trademarks are the property of their respective owners. Pentair reserves the right to change specifications without prior notice.