

**CONSTANT MOISTURE.**

# **CORROSIVE ENVIRONMENTS.**

## **THE PERFECT LOCATION FOR TMC CABLE CONNECTORS.**

Appleton TMC Connectors offer a rugged and reliable terminating solution for corrugated or interlocked armor cable in any industrial environment. TMC Connectors deliver ease of installation and maintenance and feature an integral O-Ring face seal providing NEMA 4X and IP66 protection. They also feature independent sealing and armor clamping for superior pull-out protection. With the widest cable acceptance range and reduced installation time, TMC Connectors are right for any location.

To learn more about how Appleton's TMC Cable Connectors stand up to corrosion, visit [www.appletonelec.com](http://www.appletonelec.com) or call 1.800.621.1506.



 **Appleton**<sup>®</sup>

  
**EMERSON**<sup>™</sup>  
Industrial Automation

EMERSON. CONSIDER IT SOLVED.<sup>SM</sup>

# TMC Connectors For Jacketed Metal Clad Cable

Class I, Div. 2,  
Groups A,B,C,D(1)  
Class I, Zone 1&2, AExe II  
NEMA 4X, IP66

## Applications

- TMC connectors are designed for use with the following cables: MC/MCHL – Corrugated Interlocked Aluminium/Steel Armor and Continuously Welded Armor Cables, e.g. TECK or CLX.
- TMC connectors provide a means for terminating jacketed type MC cable, forming a mechanical watertight connection and providing ground continuity for cable armor.
- Watertight-NEMA Type 4

## Features

- Integral 'O' ring face seal providing – 4X & IP66
- Independent sealing and armor clamping
- True 360° grounding
- Superior pull out prevention
- Compact slim profile
- Reduced installation time (no disassembly required)
- Widest Cable acceptance Range
- Re-usable design
- Additional Integral Deluge proof seal for protection in extreme offshore and onshore environments
- Metric option available

## Standard Materials

- Bodies, Sleeve and gland nut available in copper-free aluminum, nickel plated brass or stainless steel.
- Grounding spring is stainless steel
- Bushing is LSF-TPE (halogen-free)
- Stop and slip washers are nylon
- O-ring is Viton

## Size Ranges

- Trade sizes 1/2" thru 4"
- Cable Jacket Diameter Range: 0.354" thru 4.220"
- Cable Armor Diameter Range: 0.342" thru 4.020"

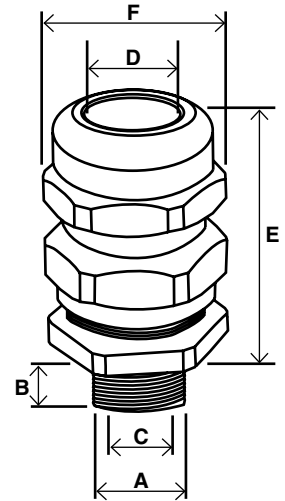

## Compliances

- UL Standard 514B, 886
- CSA Standard C22.2 No 18, 174
- IEC60079
- UL Listing File: E163112
- CSA Certificate No: 1129339
- NEMA 3, 4 & 4X and IP66

## Selection Table

Order Reference			Entry Thread 'A'	Min Thread Length 'B'	Cable Armor Diameter 'C'				Cable Jacket Diameter 'D'		Nominal Assembly Length 'E'	Envelope Diameter 'F'	
Aluminum	NP Brass	Stainless Steel			NPT	End Stop In		End Stop Out		Min			Max
						Min	Max	Min	Max				
TMC050SA	TMC050SNB	TMC050SSS	1/2"	0.59	-	-	0.342	0.503	0.354	0.547	2.20	1.31	
TMC050A	TMC050NB	TMC050SS	1/2"	0.59	-	-	0.510	0.669	0.550	0.787	2.20	1.57	
TMC050LA TMC075A	- TMC075NB	- TMC075SS	1/2" 3/4"	0.59 0.59	0.591	0.756	0.756	0.917	0.669	1.035	2.20	1.79	
TMC075LA TMC100A	- TMC100NB	- TMC100SS	3/4" 1"	0.63 0.63	0.825	0.969	0.969	1.150	0.910	1.268	2.24	2.18	
TMC100LA TMC125A	- TMC125NB	- TMC125SS	1" 1-1/4"	0.63 0.63	1.083	1.228	1.228	1.386	1.161	1.504	2.24	2.40	
TMC125LA TMC150A	- TMC150NB	- TMC150SS	1-1/4" 1-1/2"	0.63 0.63	1.320	1.461	1.461	1.618	1.402	1.736	2.37	2.62	
TMC150LA TMC200SA	- TMC200SNB	- TMC200SSS	1-1/2" 2"	0.63 0.63	1.508	1.677	1.677	1.854	1.579	2.008	2.58	3.06	
TMC150XLA TMC200A	- TMC200NB	- TMC200SS	1-1/2" 2"	0.63 0.63	1.772	1.933	1.933	2.087	1.858	2.205	2.49	3.28	
TMC200LA TMC250SA	- TMC250SNB	- TMC250SSS	2" 2-1/2"	0.90 0.90	2.052	2.161	2.161	2.320	2.079	2.441	2.50	3.49	
TMC200XLA TMC250A	- TMC250NB	- TMC250SS	2" 2-1/2"	0.90 0.90	2.247	2.406	2.406	2.545	2.327	2.677	2.52	3.71	
TMC300A	TMC300NB	TMC300SS	3"	0.98	2.543	2.776	2.776	2.965	2.622	3.126	3.57	4.80	
TMC350A	TMC350NB	TMC350SS	3-1/2"	1.437	2.913	3.291	3.291	3.485	2.992	3.827	4.61	5.82	
TMC400A	TMC400NB	TMC400SS	4"	1.437	-	-	3.500	4.020	3.700	4.220	7.66	5.84	

(1) Where explosion proof enclosures are being used, the TMC must be installed in conjunction with an approved pouring or compound sealing fitting. In Division 2 areas, the TMC can be fitted directly to an enclosure which has no source of ignition in accordance with NEC/CEC requirements.