

# 304 Stainless Steel Fittings

Stainless Steel Liquid-Tight Flexible  
Metal Conduit (LFMC) Fittings



## Construction

- Stainless Steel Type 304 fitting, has a four piece construction consisting of a gland nut, sealing ring, high tensile grounding ferrule and body.
- Designed with an insulated throat to prevent wire damage during installation.
- Included sealing washer and stainless steel lock nut provides a means for connecting the fitting to boxes.
- Excellent corrosion resistance, strength and durability.

## Installation

- Fitting is ideal for use with standard liquid-tight conduit to allow easy installation. IP 66/67 Rated when installed with approved conduit.
- Approved for both exposed and concealed locations. Rated for temperature ranges -49°F to + 221°F (-45°C to +105°C).
- Suitable for harsh industrial, food and beverage, petrochemical, waste water, salt water and other corrosive applications.
- Suitable for use in hazardous locations per NEC Articles 501 Class I Div. 2, Article 502 Class II Div. 1 & 2, Article 503 Class III Div. 1 & 2.
- Manufactured in a range of trade sizes from 3/8" through 1".
- Complies with UL Standard 514B File No. E234207.



Straight - NPT Thread 3/8" through 1"



90° - NPT Thread 3/8" through 1"



## NEC Articles

- Article 501.10 (B) (2) Class I Div. 2
- Article 502.10 (A) (2) and (B) (2) Class II Div. 1 & 2
- Article 503.10 (A) (3) and (B) Class III Div. 1 & 2

U.L. LISTED  • CSA CERTIFIED • RoHS WEEE COMPLIANT

## Stainless Steel Fittings

Type 304

### Product Specifications

### Ordering Information

Electrical Trade Size		K.O. Size	Dimensions				Approx Weight (lbs.)	Straight Fittings	
Inches	mm	Inches	Inches				PER	Standard Package	AEI PIN
3/8	12	1/2	A	B	C	D	Pkg.	25	81401292
1/2	16	1/2	1.457	0.512	1.024	-	3.5	25	81401692
3/4	21	3/4	1.457	0.512	1.142	-	4.4	10	81402092
1	27	1	1.575	0.591	1.379	-	2.4	5	81402692
			1.811	0.591	1.772	-	1.5		

Note: 1. Other sizes available on special order

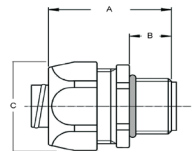

### Product Specifications

### Ordering Information

Electrical Trade Size		K.O. Size	Dimensions				Approx Weight (lbs.)	90° Fittings	
Inches	mm	Inches	Inches				PER	Standard Package	AEI PIN
3/8	12	1/2	A	B	C	D	Pkg.	10	81491292
1/2	16	1/2	1.457	0.512	1.024	1.693	2.2	10	81491692
3/4	21	3/4	1.457	0.512	1.142	1.693	2.8	10	81492092
1	27	1	1.693	0.591	1.379	1.890	3.5	5	81492692
			1.890	0.591	1.772	2.323	2.6		

Note: 1. Other sizes available on special order

