

TRAC-MASTER®

Classics

FLAT BACK SERIES
T313, T315 and T342

Project: _____

Fixture Type: _____

Location: _____

Contact/Phone: _____

PRODUCT DESCRIPTION

The simple, sleek round design make the Flat Back cylinders one of Juno's most popular series.

Construction Drawn steel housing with polycarbonate stem.

Aiming 90° vertical aiming capability and 358° rotation.

Adapter Copper alloy contacts provide precise spring action - no arcing and will not take a set • True, positive electrical ground • On/off switch included • Patented embossed polarity arrows on bottom of adapter • Spring-loaded positive latch with embossed polarity arrows secures trac light to trac • Two-position power contact provided for two-circuit application.

Labels UL listed, CSA certified.

Specifications subject to change without notice.

Line Voltage PAR/R20

Lampholder Medium base porcelain with nickel plated copper screw shell.

Catalog Number	Baffle	Finish	Lamp
T313 BLB BL	Black	Black	50W R20/50W PAR20
T313 WHB WH	White	White	50W R20/50W PAR20

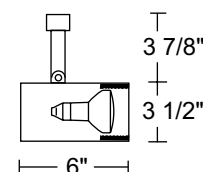
ACCESSORIES

Cat. No.	Description	Cat. No.	Description	Cat. No.	Description
HCLBL 375	Hexcell Louver - Black	DGF 375	Dichroic Glass Filter	LSPREAD 375	Linear Spread Glass Lens
CCLBL 375	Cube Cell Louver - Black	DIFF 375	Diffusion Glass Lens	T560BL	3-1/2" Diameter Accessory Holder - Black
SNOOTBL 375	Snoot - Black	UVF 375	UV Filter	T71BL	3-3/4" Diameter Barn Doors - Black
CGF 375	Color Glass Filter	SOLITE 375	Uniformity Lens (Solite)	T40N¹	Monopoint
DCCF 375	Dichroic Color Correction Filter	PRISM 375	Prismatic Spread Glass Lens		

See specification sheet [D1.2.2](#) for details. Other accessories can be found on specification sheet [D1.2.0](#).

Notes:

1 Add finish code to complete catalog number (Example: T40N WH).

Line Voltage BR30/PAR30L

Lampholder Medium base porcelain with nickel plated copper screw shell.

Catalog Number	Baffle	Finish	Lamp
T315 BLB BL	Black	Black	75W BR30/75W PAR30L
T315 WHB WH	White	White	75W BR30/75W PAR30L

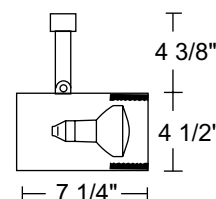
ACCESSORIES

Cat. No.	Description	Cat. No.	Description	Cat. No.	Description
HCLBL 469	Hexcell Louver - Black	DGF 469	Dichroic Glass Filter	LSPREAD 469	Linear Spread Glass Lens
CCLBL 469	Cube Cell Louver - Black	DIFF 469	Diffusion Glass Lens	T570BL	4-11/16" Diameter Accessory Holder - Black
SNOOTBL 469	Snoot - Black	UVF 469	UV Filter	T72BL	4-11/16" Diameter Barn Doors - Black
CGF 469	Color Glass Filter	SOLITE 469	Uniformity Lens (Solite)	T40N¹	Monopoint
DCCF 469	Dichroic Color Correction Filter	PRISM 469	Prismatic Spread Glass Lens		

See specification sheet [D1.2.2](#) for details. Other accessories can be found on specification sheet [D1.2.0](#).

Notes:

1 Add finish code to complete catalog number (Example: T40N WH).

TRAC-MASTER®

Classics

FLAT BACK SERIES**T313, T315 and T342****PRODUCT DESCRIPTION**

The simple, sleek round design make the Flat Back cylinders one of Juno's most popular series.

Construction Drawn steel housing with polycarbonate stem.

Aiming 90° vertical aiming capability and 358° rotation.

Adapter Copper alloy contacts provide precise spring action - no arcing and will not take a set • True, positive electrical ground • On/off switch included • Patented embossed polarity arrows on bottom of adapter • Spring-loaded positive latch with embossed polarity arrows secures trac light to trac • "Pull-up" contact to up position for two-circuit application.

Labels UL listed, CSA certified.

Specifications subject to change without notice.

Line Voltage PAR38

Lampholder Medium base porcelain with nickel plated copper screw shell.

Catalog Number	Baffle	Finish	Lamp
T342 BLB BL	Black	Black	250W PAR38

ACCESSORIES

Cat. No.	Description	Cat. No.	Description
CGF 550	Color Glass Filter	T73BL	5-1/2" Diameter Barn Doors - Black †
CCLBL 550	Cube Cell Louver - Black	T73WH	5-1/2" Diameter Barn Doors - White †
T580BL	5-1/2" Diameter Accessory Holder - Black	T40N¹	Monopoint

See specification sheet [D1.2.2](#) for details. Other accessories can be found on specification sheet [D1.2.0](#).

† Barn Doors accept Color Filters and Louvers.

Notes:

1 Add finish code to complete catalog number (Example: T40N WH).

