



Main

| | |
|------------------------------|--|
| Range of Product | Modicon TM5 |
| Product or Component Type | Power distribution module |
| Product Specific Application | Supply 24 V DC I/O modules and bus TM5 |

Complementary

| | |
|--------------------------------|---|
| Range Compatibility | Modicon LMC058 Modicon M258 |
| Product Compatibility | Motion controller Logic controller |
| [Us] rated supply voltage | 24 V |
| Network type | DC |
| Current supplied | 1136 MA TM5 power bus 14...131 °F (-10...55 °C) 740 MA TM5 power bus 131...140 °F (55...60 °C) 10 A I/O power segment |
| Maximum power dissipation in W | 1.91 W |
| Color | Gray |
| Short-circuit protection | 10 A external fuse |
| Current consumption | <= 25 mA 24 V DC |
| Marking | CE |

Environment

| | |
|---------------------------------------|--|
| Standards | UL 508 CSA C22.2 No 213 CSA C22.2 No 142 IEC 61131-2 |
| Product Certifications | CSA C-tick CULus GOST-R |
| Ambient air temperature for operation | 14...131 °F (-10...55 °C) without derating horizontal installation) 131...140 °F (55...60 °C) with derating factor horizontal installation) 14...122 °F (-10...50 °C) vertical installation) |
| Ambient Air Temperature for Storage | -13...158 °F (-25...70 °C) |
| Relative humidity | 5...95 % without condensation |
| Operating altitude | 0...6561.68 ft (0...2000 m) |
| Storage altitude | 0.00...9842.52 ft (0...3000 m) |
| Vibration resistance | 1 gn 8.4...150 Hz DIN rail 3.5 mm 5...8.4 Hz DIN rail |
| Shock resistance | 15 gn 11 ms |
| Resistance to electrostatic discharge | 4 KV on contact EN/IEC 61000-4-2 8 kV in air EN/IEC 61000-4-2 |
| Resistance to electromagnetic fields | 0.91 V/m (1 V/m) 2...2.7 GHz EN/IEC 61000-4-3 9.14 V/m (10 V/m) 80...2000 MHz EN/IEC 61000-4-3 |

| | |
|--------------------------------|---|
| Resistance to fast transients | 1 KV EN/IEC 61000-4-4 I/O) 1 KV EN/IEC 61000-4-4 shielded cable) 2 kV EN/IEC 61000-4-4 power lines) |
| Surge withstand | 0.5 KV differential mode EN/IEC 61000-4-5 1 kV common mode EN/IEC 61000-4-5 |
| Electromagnetic compatibility | EN/IEC 61000-4-6 |
| Disturbance radiated/conducted | CISPR 11 |

Ordering and shipping details

| | |
|-----------------------|------------------|
| Category | 22532-M258 PLC |
| Discount Schedule | PC12 |
| GTIN | 3595864074924 |
| Nbr. of units in pkg. | 1 |
| Package weight(Lbs) | 1.90 oz (54.0 g) |
| Returnability | Yes |
| Country of origin | AT |

Packing Units

| | |
|------------------------------|-------------------------|
| Unit Type of Package 1 | PCE |
| Package 1 Height | 0.79 in (2 cm) |
| Package 1 width | 2.36 in (6 cm) |
| Package 1 Length | 4.13 in (10.5 cm) |
| Unit Type of Package 2 | S02 |
| Number of Units in Package 2 | 97 |
| Package 2 Weight | 12.21 lb(US) (5.538 kg) |
| Package 2 Height | 5.91 in (15 cm) |
| Package 2 width | 11.81 in (30 cm) |
| Package 2 Length | 15.75 in (40 cm) |

Offer Sustainability

| | |
|----------------------------|---|
| Sustainable offer status | Green Premium product |
| California proposition 65 | WARNING: This product can expose you to chemicals including: Lead and lead compounds, which is known to the State of California to cause cancer and birth defects or other reproductive harm. For more information go to www.P65Warnings.ca.gov |
| REACH Regulation | REACH Declaration |
| REACH free of SVHC | Yes |
| EU RoHS Directive | Pro-active compliance (Product out of EU RoHS legal scope) EU RoHS Declaration |
| Toxic heavy metal free | Yes |
| Mercury free | Yes |
| RoHS exemption information | Yes |
| China RoHS Regulation | China RoHS Declaration |
| Environmental Disclosure | Product Environmental Profile |
| Circularity Profile | End Of Life Information |
| WEEE | The product must be disposed on European Union markets following specific waste collection and never end up in rubbish bins. |
| PVC free | Yes |

Contractual warranty

| | |
|----------|-----------|
| Warranty | 18 months |
|----------|-----------|

TM5 Slice

Dimensions

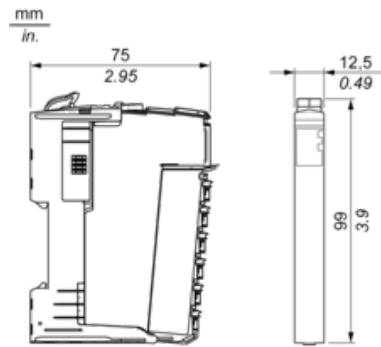

TM5 System

Spacing Requirements

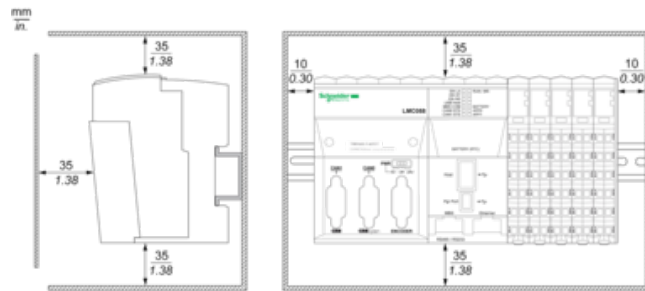



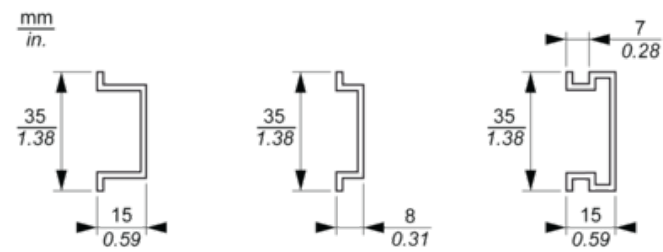

Mounting on a DIN Rail



TM5 System Wiring Recommendations

Wire Sizes to Use with the Removable Spring Terminal Blocks

| mm in. |  |  |  |  |
|-----------------|---|---|---|---|
| mm ² | 0,08...2,5 | 0,25...2,5 | 0,25...1,5 | 2 x 0,25...2 x 0,75 |
| AWG | 28...14 | 24...14 | 24...16 | 2 x 24...2 x 18 |

PDM Electronic Module 24 Vdc I/O and TM5 Power Bus

Wiring Diagram

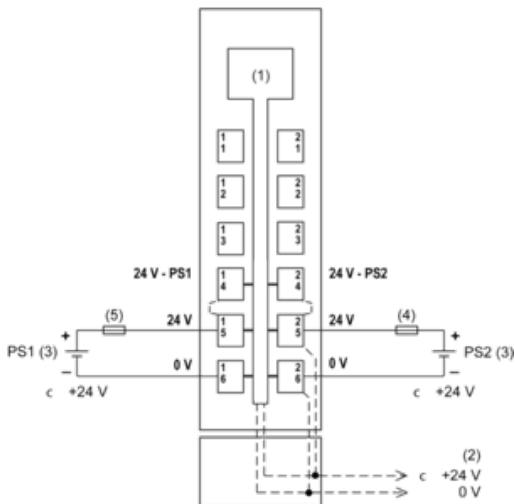

- (1) Internal electronics
- (2) 24 Vdc I/O power segment integrated into the bus bases
- (3) PS1/PS2: External isolated SELV power supplies 24 Vdc limited to 200 VA for UL508 conformance, or limited to 150 VA for CSA 22.2, N ° 142 conformance
- (4) External fuse type T slow-blow 10 A max. 250 V
- (5) External fuse type T slow-blow 1 A 250 V