

BRANCH UNIT AVAILABLE WITH ALL COPPER BUSSING ADD SUFFIX "CU" TO CATALOG NUMBER (EXAMPLE: EZML334225CU).

FOR METERING EQUIPMENT SHORT CIRCUIT CURRENT RATINGS REFER TO SQUARE D DIGEST 173, PAGE 2-8.

TENANT SERVICE DISCONNECTS (ORDER ONE PER SOCKET POSITION)			
TENANT CIRCUIT BREAKER (3-POLE)	AMPERE RATINGS MIN. - MAX.	SHORT CIRCUIT BREAKER RATING RMS SYMMETRICAL AMPERES MAX.	VOLTS MAX.
DBP-TM	70 - 225	10,000	240/120
DDP-TM	70 - 225	25,000	
DGP-TM	70 - 225	65,000	
GJP-TM	70 - 225	100,000 ▼	

▼ RATED 100kA MAX. AT 2DBY/120 VAC, 65 kA MAX. AT 240/120 VAC

SYMBOL	CONDUIT SIZE	
	IN	MM
A	.50	13
B	.75	19
D	1.25	32
E	1.50	38
F	2.00	51
G	2.50	64

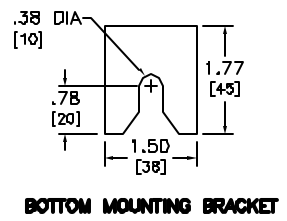
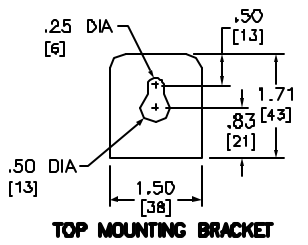
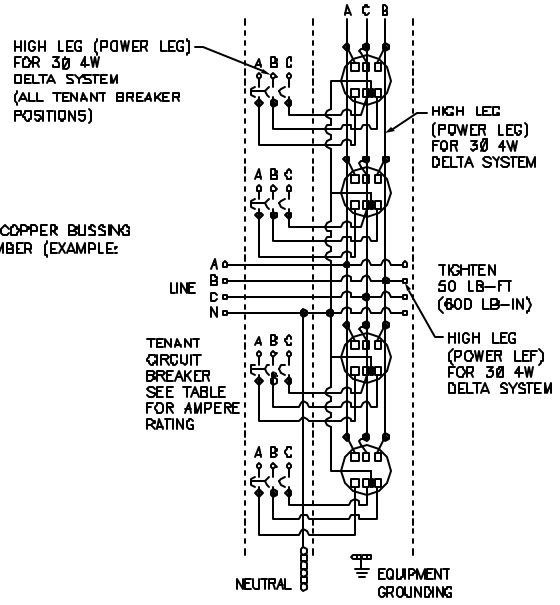

DUAL DIMENSIONS: INCHES MILLIMETERS

EZML334225, EZMR334225

SYSTEM TYPE (N)	SERVICE PROVIDED (DUT)	CATALOG NUMBER	METER SOCKET TYPE	NUMBER OF POSITIONS	TENANT CIRCUIT BREAKER (ORDER SEPARATELY)	NEUTRAL WIRE RANGE	EQUIPMENT GROUND LUG WIRE RANGE
30 4W 240/120 VAC DELTA OR 2DBY/120 VAC	30 4W 240/120 VAC DELTA OR 2DBY/120 VAC	EZMR334225	7-JAW RINGLESS TYPE WITHOUT BYPASS	4	3-POLE SEE TABLE ABOVE	#6-300 KCMIL CU/AL	#14-2/0 KCMIL CU #12-2/0 KCMIL AL
		EZML334225	7-JAW RINGLESS TYPE WITH LEVER BYPASS AND JAW RELEASE				

NOTES:  
 FINISH - GRAY BAKED ENAMEL POWDER COAT PAINT OVER CLEANED GALVANNEALED STEEL.  
 UL LISTED - FILE E-131840, VOL. 11  
 SUITABLE FOR USE AS SERVICE EQUIPMENT.  
 MAIN HORIZONTAL CROSS BUS RATED AT 1200 AMPERES.  
 GANGABLE MULTI-METERING EQUIPMENT IS DESIGNED FOR WALL MOUNTING ONLY.  
 (NOT SUITABLE FOR FLOOR STANDING EQUIPMENT).  
 UNMETERED COMPARTMENTS ARE SEALABLE BY UTILITY.

EZ METER-PAK GANGABLE MULTI-METERING EQUIPMENT  
 225 MAX 3PH 4W METER SOCKET/CIRCUIT BREAKER  
 4-GANG BRANCH UNITS  
 RAINPROOF NEMA TYPE 3R ENCLOSURES



DWG# 3292  
NO.