

## Product data sheet

### Characteristics

# 9001KN379

Harmony 9001K, Harmony 9001SK, legend, 30mm, aluminium, black with silver letters, 44x50mm, marking PULL TO START/PUSH TO STOP



### Main

Range of Product	Harmony 9001K Harmony 9001SK
Product or Component Type	Marked legend
Accessory / Separate Part Type	Legend plate
Accessory / separate part category	Marking accessory
Accessory / separate part destination	Control and signalling units Ø 30 mm (metal range)
Label dimensions	44 x 50 mm
Marking	White PULL TO START/PUSH TO STOP black
User Language	English

### Complementary

Mounting diameter	1.18 in (30 mm)
Material	Aluminium
Net Weight	0.01 lb(US) (0.005 kg)
Size	30 mm
Colour of marking	Silver
Background colour	Black
Marking	PULL TO START/PUSH TO STOP

### Ordering and shipping details

Category	21433-9001 ACCESS FOR K,KX,SK
Discount Schedule	CS1
GTIN	3389110946512
Nbr. of units in pkg.	1
Package weight(Lbs)	0.16 oz (4.536 g)
Returnability	Yes
Country of origin	US

### Packing Units

Unit Type of Package 1	PCE
Package 1 Height	0.12 in (0.3 cm)
Package 1 width	1.77 in (4.501 cm)
Package 1 Length	1.77 in (4.501 cm)

The information provided in this documentation contains general descriptions and/or technical characteristics of the performance of the products contained herein. This documentation is not intended as a substitute for and is not to be used for determining suitability or reliability of these products for specific user applications. It is the duty of any such user or integrator to perform the appropriate and complete risk analysis, evaluation and testing of the products with respect to the relevant specific application or use thereof. Neither Schneider Electric Industries SAS nor any of its affiliates or subsidiaries shall be responsible or liable for misuse of the information contained herein.

## Offer Sustainability

Sustainable offer status	Green Premium product
California proposition 65	WARNING: This product can expose you to chemicals including: Nickel compounds, which is known to the State of California to cause cancer, and Di-isodecyl phthalate (DIDP), which is known to the State of California to cause birth defects or other reproductive harm. For more information go to <a href="http://www.P65Warnings.ca.gov">www.P65Warnings.ca.gov</a>
REACH Regulation	<a href="#">REACH Declaration</a>
EU RoHS Directive	Pro-active compliance (Product out of EU RoHS legal scope) <a href="#">EU RoHS Declaration</a>
Mercury free	Yes
RoHS exemption information	<a href="#">Yes</a>
China RoHS Regulation	<a href="#">China RoHS Declaration</a>
Environmental Disclosure	<a href="#">Product Environmental Profile</a>

## Contractual warranty

Warranty	18 months
----------	-----------

Dimensions

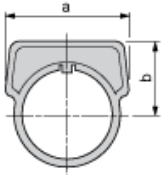

a		b	
mm	in.	mm	in.
44.5	1.75	31.4	1.24