



### Main

Range of Product	Harmony 9001K Harmony 9001SK
Product or Component Type	Marked legend
Accessory / Separate Part Type	Legend plate
Accessory / separate part category	Marking accessory
Accessory / separate part destination	Control and signalling units Ø 30 mm (metal range)
Label dimensions	40 x 43 mm
Marking	White EMERGENCY STOP red
User Language	English

### Complementary

Mounting diameter	1.18 in (30 mm)
Material	Aluminium
Net Weight	0.01 lb(US) (0.005 kg)
Size	30 mm
Colour of marking	Silver
Background colour	Red
Marking	EMERGENCY STOP

### Ordering and shipping details

Category	21433-9001 ACCESS FOR K,KX,SK
Discount Schedule	CS1
GTIN	3389110946291
Nbr. of units in pkg.	1
Package weight(Lbs)	0.16 oz (4.536 g)
Returnability	Yes
Country of origin	US

### Packing Units

Unit Type of Package 1	PCE
Package 1 Height	0.10 in (0.254 cm)
Package 1 width	1.60 in (4.064 cm)
Package 1 Length	1.70 in (4.318 cm)
Unit Type of Package 2	BB1
Number of Units in Package 2	50
Package 2 Weight	8.01 oz (227.0 g)
Package 2 Height	2.13 in (5.4 cm)
Package 2 width	1.81 in (4.6 cm)
Package 2 Length	3.70 in (9.4 cm)

## Offer Sustainability

Sustainable offer status	Green Premium product
California proposition 65	WARNING: This product can expose you to chemicals including: Nickel compounds, which is known to the State of California to cause cancer, and Di-isodecyl phthalate (DIDP), which is known to the State of California to cause birth defects or other reproductive harm. For more information go to <a href="http://www.P65Warnings.ca.gov">www.P65Warnings.ca.gov</a>
REACH Regulation	<a href="#">REACH Declaration</a>
EU RoHS Directive	Pro-active compliance (Product out of EU RoHS legal scope) <a href="#">EU RoHS Declaration</a>
Mercury free	Yes
RoHS exemption information	<a href="#">Yes</a>
China RoHS Regulation	<a href="#">China RoHS Declaration</a>
Environmental Disclosure	<a href="#">Product Environmental Profile</a>

## Contractual warranty

Warranty	18 months
----------	-----------

Dimensions

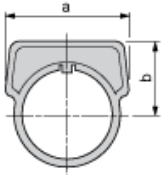

a		b	
mm	in.	mm	in.
41.3	1.62	24.6	0.97