

Panel Thickness E dim. inches (mm)	Number of Gasket
1/16 (1.6)	4
1/8 (3.2)	3
3/16 (4.8)	2
1/4 (6.4)	1

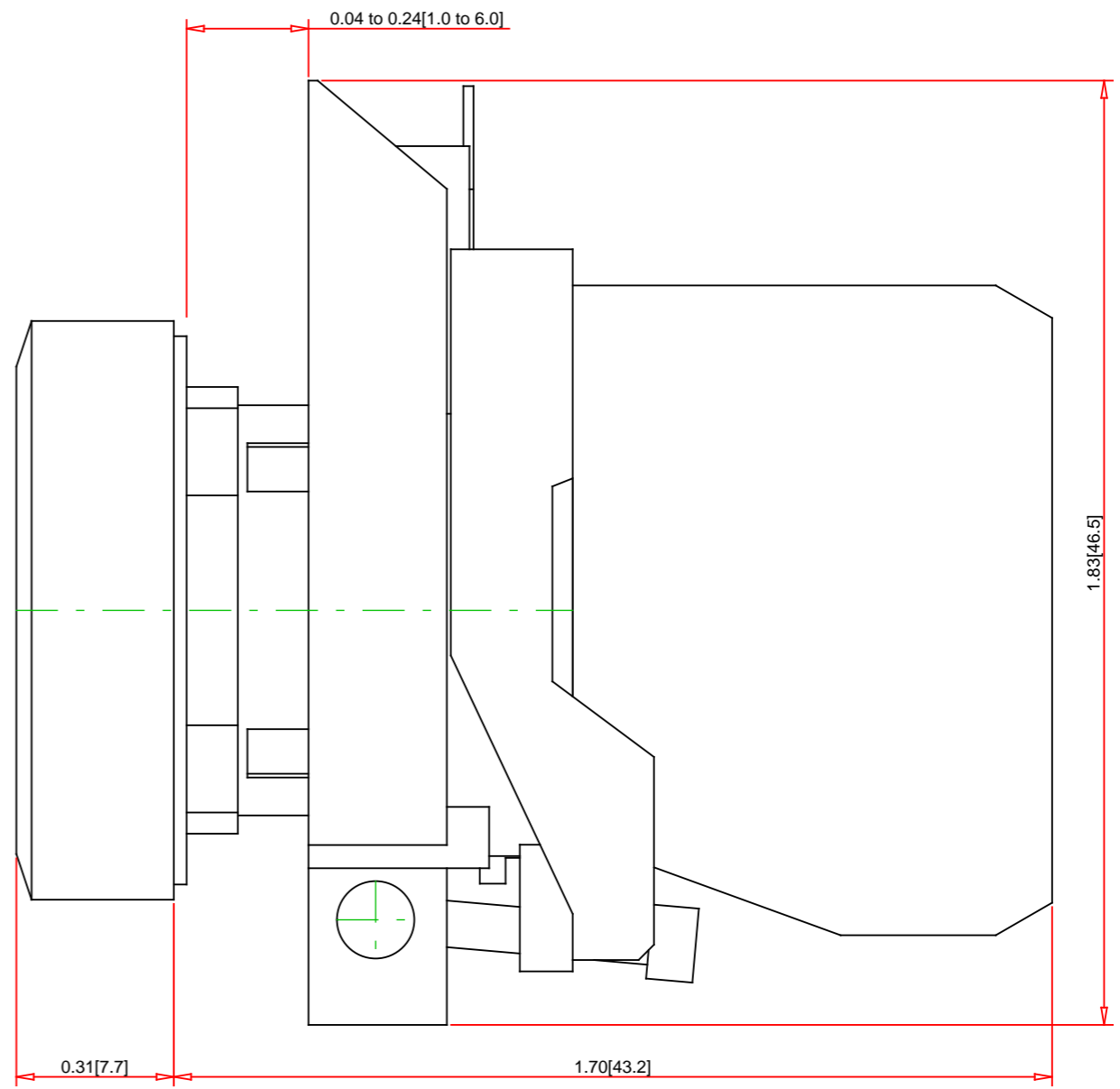
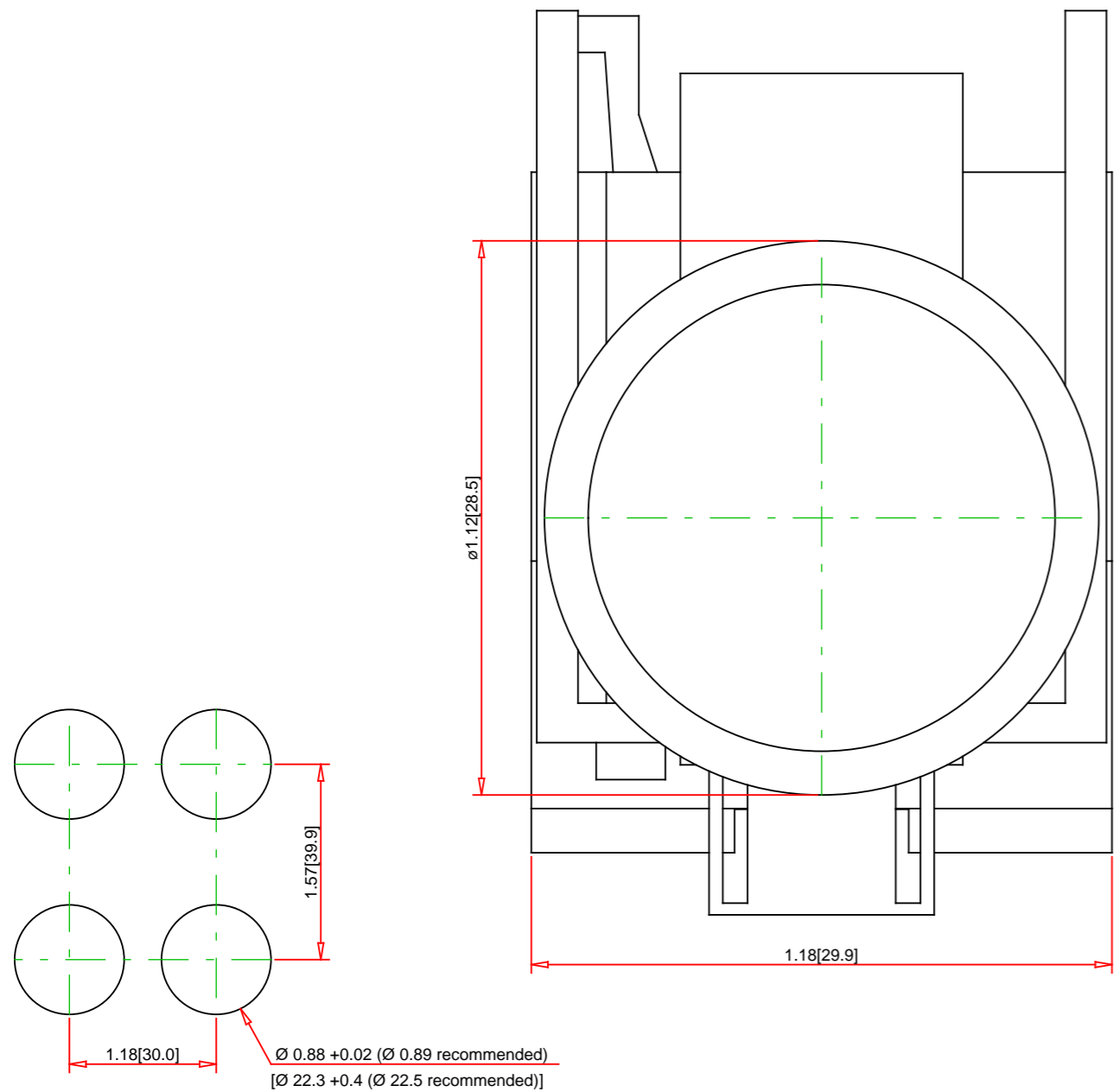

**Note:**  
- Drawings Not To Scale  
- Drawings Subject to Change Without Notice  
- Dimensions are inches next to [Millimeters]

Part No.:

**XB4AB1**

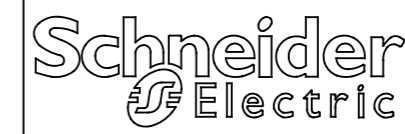

Schneider Electric United States  
North American Division  
Boston One Campus  
800 Federal Street  
Andover, MA 01810, USA  
Phone: +1 8773425173  
Email: CCC@us.schneider-electric.com

**Technical Information:**

Circuit Configuration:	SPST
Electrical Life:	100000
Mechanical Life:	5000000
Operating Temp. Range:	-25 to 70 °C (-13 to 158 °F)
Power Rating:	Not HP Rated
Number of Poles:	1 N.O. + 1 N.C.
AC Voltage:	600
Current Rating:	10
Contact Rating:	AC-15: 600V, 1.2A; 240V, 3A; 120V, 6A DC-13: 600V, 0.1A; 250V, 0.27A; 125V, 0.55A

**Specification:**

Description:	Push Buttons 22 mm - Assemblies
Type:	Push Button
Actuator Type:	Plunger
Illumination:	None
Terminal Plating:	Copper/Nickel
Actuator Color:	Assorted
Actuator Part No.:	ZB4BA9
Base and Block Part No.:	ZB4BZ101