

THIS COPY IS PROVIDED ON A RESTRICTED BASIS AND IS NOT TO BE USED IN ANY WAY DETRIMENTAL TO THE INTERESTS OF PANDUIT CORP.

NOTES, UNLESS OTHERWISE SPECIFIED:

1. DIMENSIONS IN BRACKETS ARE IN METRIC. (A)
2. RECOMMENDED TOOL: CT-3001/ST SERIES (A)
3. COMPATIBLE TOOLS: CT-3001/CCP SERIES, CT-930LPCH
4. WIRE SIZE: 4/0, 250kcmil
5. CRIMPS: F91 FERRULES - ALL SIZES
6. DIE HALVES ARE HEAT TREATED TO Rc 32-35
7. DIE HALVES ARE NICKLON PLATED FOR LUBRICITY/DURABILITY
8. DIE HALVES AND PLATING ARE RoHS COMPLIANT (A)

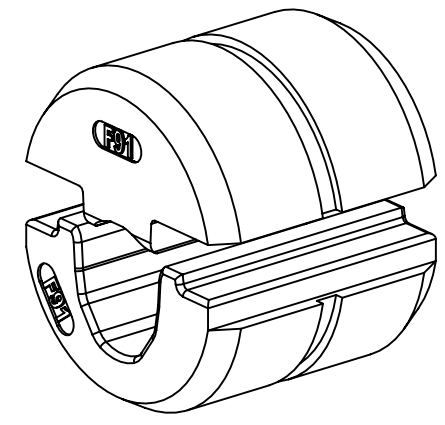
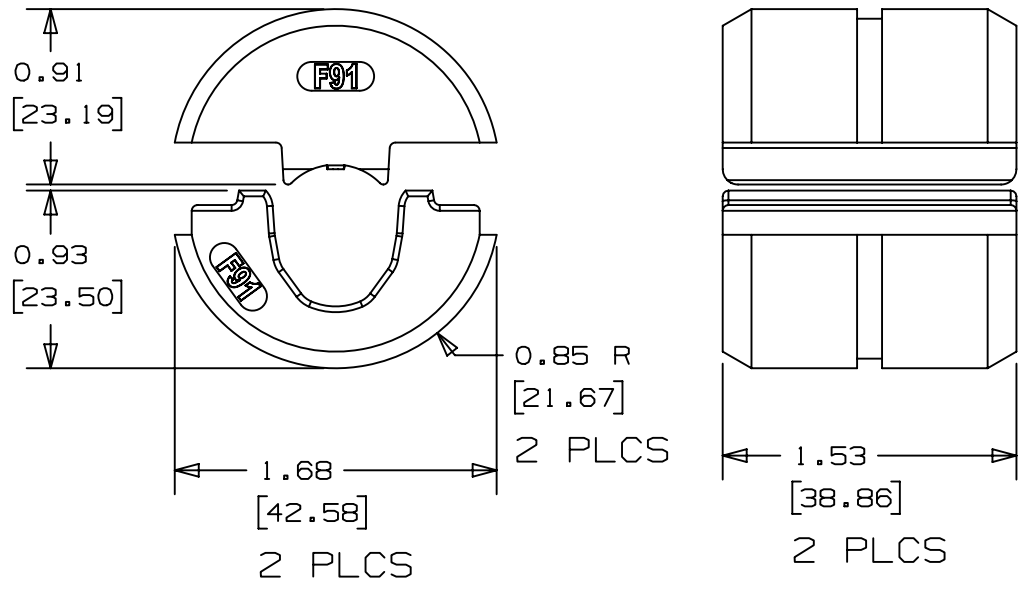

REV	DATE	BY	CHK	APR	DESCRIPTION	ECN
02	11-2-17	BJPU	JEH	JADE	REMOVED CT-2931/ST AND CT-920CH TOOLS, ADDED CT-3001/CCP SERIES TOOL, ADDED NOTE #8 (A)	017591
01	8-28-17	BJPU	JEH	JADE	OFFICIAL RELEASE OF CD-920-F91 CUSTOMER DRAWING	013588
00	03-30-17	BJPU	JEH	JADE	RELEASED	---

INSTALLATION INSTRUCTION NUMBER PA28870A01		WORK INSTRUCTION FMEA & CONTROL PLAN NUMBER N/A	
TITLE CD-920-F91 CUSTOMER DRAWING			
CUSTOMER DRAWING			
ITEM REVISION NAME R28877AA/02		PANDUIT	
DATASET FILE NAME R28877AA_DS_TD28877A01/02			
UNLESS OTHERWISE SPECIFIED, DIMENSIONAL TOLERANCES ARE: IN [mm] .x ± .1 [2.54] .xxx ± .005 [.127] .xx ± .01 [.25] ANGLES ± 5 °		MATERIAL: 4140 STEEL / RC 32-35	
THIRD ANGLE PROJECTION		DRAWING NUMBER: TD28877A01	
DRAWN BY BJPU	DATE 03/30/17	CHK JADE	SCALE 1:1
SHT 1 OF 1		SIZE A	